

REV
A 0460-010-20 **

REVISIONS			
SYM	DESCRIPTION	DATE	APPROVED
NC	NEW RELEASE PER E.O. P19622	9/19/07	R.D.R.
A	REVISED PER E.O. P20270	7-27-09	RDR

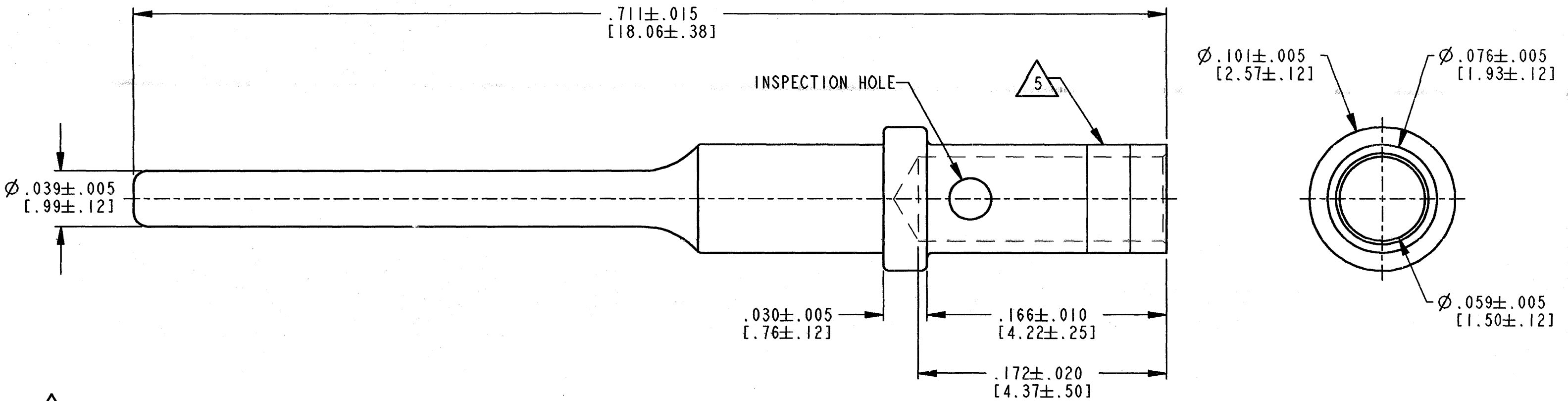

5. PIN CONTACT IS IDENTIFIED BY A SINGE PURPLE STRIPE.
4. FOR CONTACT PERFORMANCE AND APPLICATION CHARACTERISTICS SEE DRAWING 0425-015-0000.
3. THIS CONTACT MAY BE CRIMPED WITH HDP-400 POWER PRESS OR HDT-48-00 HAND TOOL. SEE DRAWING 0425-205-0000 FOR APPLICABLE WIRE SIZE AND CRIMPING INFORMATION.
2. WHEN ** = 31: PLATING IS GOLD
** = 141: PLATING IS NICKEL
1. DIMENSIONS ARE IN INCHES [mm]

NOTES: UNLESS OTHERWISE SPECIFIED

SIGNATURE & DATE	
DR	D. MEYER 08-22-07
CHK	D Meyer 7/23/09
PE	D Meyer 7/23/09
APPD	R. Reed 7-27-09
SCALE	NONE WT _____

CONTACT PIN
SIZE 20
16-18 AWG

ENVELOPE

EP	MATL. CODE
3850 INDUSTRIAL AVE. HEMET, CA 92545	
B 0460-010-20 **	
DWG SIZE	CODE 11139 SHEET 1 OF 1